

OPERATION & SAFETY INSTRUCTIONS

PROTEX VORTEX A/C

Models 8115, 8125, 8135, 8170
(Includes all BSP versions of models listed above)



Baseefa 16ATEX0166X

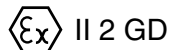

Ex h IIC T3 Gb

Ex h IIIC T200°C Db

Ta +10°C to +80°C

IECEX SGS 23.0053X

IMPORTANT

Please read all instructions BEFORE attempting to use this product



ITW Air Management

10125 Carver Road, Cincinnati, OH 45242
Phone: 513-891-7474 • Fax: 513-891-4092

Toll Free: 800-441-7475

www.vortec.com • techsupport@vortec.com

GENERAL SAFETY CONSIDERATIONS

WARNING: COMPRESSED AIR COULD CAUSE DEATH, BLINDNESS OR INJURY. METAL SURFACES GET VERY HOT.

1. Do not operate a ProtEX Vortex A/C at compressed air pressures above 100 psig (6.9 bar).
2. Do not operate at compressed air temperatures above 120°F (49°C).
3. Avoid direct contact with compressed air.
4. Do not direct compressed air at any person.
5. When using compressed air, wear safety glasses with side shields.

WARNING! Explosion Hazard: Substitution of components may impair suitability for Zone 1 and Zone 21 and for Class I, II and III; Division 1

SPECIFIC CONDITIONS OF USE

1. When the equipment is to be used on an enclosure intended to be protected by a concept according to EN / IEC 60079-2, the pressurized air supply to the equipment must be of the same quality as that used to purge and pressurize the enclosure to which it is installed on.
2. When the equipment is to be used on an enclosure intended to be protected by a concept according to EN / IEC 60079-2, the equipment shall be fitted to, and assessed/tested, as part of the enclosure.
3. The equipment shall be suitably earthed (grounded) prior to operation. Earth continuity shall be maintained between the equipment and the enclosure to which it is installed on.
4. The equipment shall be mounted to the top or side face of the enclosure to which it is to be installed.
5. Inlet pressure shall not exceed 100 psig (6.9 bar).
6. Inlet air temperature shall not exceed 120°F (49°C).
7. WARNING: Potential Electrostatic charging hazard – clean only with a damp cloth.
8. When installed, consideration shall be given to the guidance given in PD IEC/TS 60079-32-1 'Explosive atmospheres - Electrostatic hazards, guidance'.

Introduction

The ProtEX Vortex A/C is designed to cool industrial control cabinets located in Zone 1 and Zone 21 and Class I, Division 1, Groups A, B, C and D; Class II, Division 1, Groups F and G and Class III hazardous locations, using only filtered and dried compressed air to generate the cooling. The ProtEX Vortex A/C shall only be used in conjunction with a properly sized enclosure purge and pressurization system that must be able to vent the additional air introduced by the ProtEX Vortex A/C. (The purge and pressurization system must be selected and supplied by the end user.)

The purge system must be selected based on the electrical ratings of the protected equipment and the intended hazardous location:

- A Type X purge system reduces the area classification within the purged enclosure from Div. 1 / Zone 1 to non-hazardous.

- A Type Y purge system reduces the area classification within the purged enclosure from Div. 1 / Zone 1 to Div. 2 / Zone 2.
- A Type Z purge system reduces the area classification within the purged enclosure from Div. 2 / Zone 2 to non-hazardous.

The cooling air produced by the ProtEX Vortex A/C in the enclosure is vented into the hazardous area (outside of the enclosure) through the purge system's spark arrestor vent. The spark arrestor vent must be properly sized to accept the additional cold air flow generated by the ProtEX Vortex A/C to prevent over-pressurization of the enclosure.

It is the end user's responsibility to ensure that the correct spark arrestor vent is used and that the purge system functions properly when integrated with the ProtEX Vortex A/C.

DO NOT operate the ProtEX Vortex A/C on a sealed and unvented enclosure as pressure in the enclosure will increase and damage or injury could result. The ProtEX Vortex A/C has a built-in mechanical thermostat that requires no electricity.

Compressed Air Supply

The compressed air system's intake must originate in a non-hazardous area. Compressed air piping must be fabricated from noncombustible materials suitable for the conditions present. The pressurized air supply provided to the ProtEX Vortex A/C must be of the same quality as that used to purge and pressurize the enclosure it is installed on. The Model 8170 will require up to 70 scfm (1980 lpm) of compressed air at 90–100 psig (6–6.9 bar) when both stages of the unit are operating at full capacity.

The compressed air supply must be filtered (5 micron maximum) to remove water and dirt. The 5 micron filter is supplied for this purpose:

- Vortec model 704S-24A, 704S-36A, 705S-24A or 705S-36A with single unit models
- Vortec model 704S-40A or model 705S-40A with double unit models

If oil is present in the compressed air supply, remove the oil using an optional 0.01 micron coalescing filter (Vortec model 701S-48 or 701S-54). If an oil removal filter is necessary, install it downstream of the 5 micron filter. Locate the filters in a non-hazardous location to facilitate easy filter element changes. Change the filter elements as needed (see "Maintenance").

It is highly recommended to dry the compressed air (to remove water vapor) using a refrigerated air dryer. Failure to dry the air adequately may result in frost or ice forming internally and resulting in decreased cooling air flow and cooling capacity, and will void the warranty.

For Models 8115, 8125, 8135: Supply compressed air to the ProtEX Vortex A/C with 3/8" schedule 40 pipe when the pipe length is less than 30 feet (9 meters). If pipe length exceeds 30 feet (9 meters), refer to "Table 2: Determining Compressed Air Line Size" or contact Vortec for assistance.

For Model 8170: Supply compressed air to the ProtEX Vortex A/C with 3/8" schedule 40 pipe when the pipe length is less than 10 feet (3 meters). If pipe length exceeds 10 feet (3 meters) but is less than 30 feet (9 meters), use 1/2" pipe. If pipe length exceeds 30 feet (9 meters) but is less than 100 feet (30 meters), use 3/4" pipe. Use appropriate pipe adapter fittings when terminating the supply pipe at the ProtEX Vortex A/C. (The model 704S-40A compressed air filter that is supplied with the model 8170 has 3/4"-14 NPT ports. The model 705S-40A compressed air filter that is supplied with the 8170BSP has 3/4"-14 BSPP ports.)

Installation

Install in accordance with the National Electrical Code (NEC), Canadian Electrical Code (CEC), and applicable local codes (ex. NFPA 496). If the ProtEX Vortex A/C is installed in a Class II, Division 1 environment; avoid mounting locations where dust may be readily disturbed by the hot exhaust flow from the stainless steel exhaust shroud. Avoid mounting locations where the hot exhaust from the ProtEX Vortex A/C could disturb dust that has collected on surfaces.

1. The ProtEX Vortex A/C must be installed on the top of the enclosure on a flat horizontal surface of the enclosure. Alternately, the ProtEX Vortex A/C can be mounted on the side of the enclosure. When the unit is side mounted (on a flat vertical surface of the enclosure), the compressed air inlet for Models 81x5 must be pointing up, and the stainless steel shroud must face down; for Model 8170 (dual unit) the compressed air inlet must be pointing down, and the stainless steel shroud must face down toward the floor. If side mounted, it is best if the unit is located near the top of the enclosure.
2. Find a location for the ProtEX Vortex A/C on your enclosure so that there is sufficient clearance for the internal mechanical thermostat(s), cold air outlet(s) and check valve assembly (assemblies, for dual units), and so that the entire mounting "footprint" of the ProtEX Vortex A/C is supported by the enclosure.
 - For Models 81x5: 4 3/4" wide x 3 9/16" (121 mm x 90 mm)
 - For Model 8170: 10 1/4" wide x 3 9/16" (260 mm x 90 mm)

Position the unit so that the stainless steel shroud on the back of the unit is away from personnel, if possible. Also, position so that no internal enclosure components obstruct air flow around the mechanical thermostat(s). The ProtEX Vortex A/C should be located adjacent to the purge system's spark arrestor vent. This will allow the mechanical thermostat(s) to sense temperature of the airflow exiting the vent and respond faster to the temperature changes in the enclosure.

3. Cut a 1 15/16" (49 mm) diameter hole (1 1/2" knockout size) for the single units, and two holes on 4" (102 mm) centers for the dual unit, in the selected location of the flat horizontal (or vertical) surface of the enclosure. De-burr any sharp edges around the hole(s).
4. Remove the 1 1/2" electrical locknut(s) from the ProtEX Vortex A/C. Insert the threaded portion(s) of the ProtEX Vortex A/C into the 1 15/16" (49 mm) hole(s) in the enclosure. (Be careful not to damage the mechanical thermostat(s) during installation.)
5. From inside the enclosure, screw the 1 1/2" electrical locknut(s) onto the threads of the ProtEX Vortex A/C. Tighten the locknut(s) securely to compress the 1/8" (3 mm) thick sealing gasket(s) located between the enclosure surface and the ProtEX Vortex A/C.
6. Attach the Check Valve assembly (assemblies) to the cold air outlet(s) of the ProtEX Vortex A/C (a 3/8"-18 NPT thread) inside the enclosure. The Check Valve(s) can be attached to the ProtEX Vortex A/C with the supplied 3/8" NPT straight pipe nipple(s) OR with the supplied 3/8" NPT pipe elbow(s). The orientation of each Check Valve assembly is not important, it will function in any position, however, the airflow direction through the Check Valve(s) is (are) important. Attach the Check Valve(s) so that the arrow on the valve(s) points away from the ProtEX Vortex A/C. Suitability of the Check Valve(s), provided with the ProtEX Vortex A/C, to prevent air from leaking out from the purged and pressurized enclosure must be verified during installation.
7. Mount the Cold Air Muffler(s) inside the enclosure cooler near the ProtEX Vortex A/C. You will need a surface area of approximately 2" x 9" (50 mm x 230 mm) to mount each muffler. The Muffler(s) can be mounted in any orientation: horizontal or vertical. Using the supplied Muffler Mounting Clamp(s) (with double sided tape), attach the Clamp(s) at the desired location. (Clean the mounting surfaces so that the double sided tape bonds securely.)
8. If desired, the Clamp(s) can be permanently mounted to the enclosure using the supplied mounting hardware. Two 5/32" (4 mm) diameter holes positioned on 3/4" (19 mm) centers must be drilled to mount the Muffler Clamp with the supplied plastic push-rivets.
9. Snap the Cold Air Muffler(s) into the Mounting Clamp(s).
10. Cut a sufficient length of the 5/8" (16 mm) inside diameter vinyl tubing from the supplied #7000-75 Cold Air Ducting Kit(s) to connect the outlet(s) of the Check Valve(s) to the Cold Air Muffler(s). Attach the length(s) of vinyl tubing securely onto the hose barbs of the Check Valve(s) and the Muffler(s). Ensure that the vinyl tubing has no sharp bends or kinks. Direction of cold air flow through the Muffler(s) is not important.
11. Attach all (or a portion of) the remaining supplied vinyl tubing of the Cold Air Ducting Kit(s) to the opposite hose barb connection on the Cold Air Muffler(s). Holes can be punched or drilled into this 5/8" (16 mm) tubing

to distribute the cold air evenly inside your enclosure, or, the entire cold air output can be directed to a heat sensitive component. If the end of the 5/8" (16 mm) vinyl tubing is plugged, at least 25 x 1/8" (3 mm) diameter holes should be punched or drilled into the tubing to allow the cold air to escape. Use the six self adhesive tubing clamps provided in the kit to locate and hold the vinyl tubing.

12. Connect the compressed air filter to the compressed air inlet on the side of the ProtEX Vortex A/C with the appropriate size piping as recommended in Table 2. The filter should be located in a non-hazardous area and where the temperature does not exceed 125°F (52°C).

- For Models 81x5, the port sizes on both the filter and the unit are 3/8"-18 NPT (3/8"-19 BSPP on BSP models)
- For Model 8170, the port sizes on the filter are 3/4"-14 NPT and 3/8"-18 NPT on the unit (3/4"-14 BSPP and 3/8"-19 BSPP on BSP models)

Use a 13/16" (21 mm) wrench to hold the air fitting on the side of the ProtEX Vortex A/C stationary while tightening the pipe connections. Note the air flow direction arrow on top of the filter.

13. Connect the compressed air supply to the inlet of the air filter. See "Compressed Air Supply".

Operation

The enclosure that the ProtEX Vortex A/C is installed on MUST be purged and pressurized BEFORE the ProtEX Vortex A/C is operated. Ensure that the cool air flow does not impede the circulation of the purge air flow from the purge system.

It is recommended to operate the ProtEX Vortex A/C at 90–100 psig (6–6.9 bar) compressed air pressure. If compressed air pressure exceeds 100 psig (6.9 bar), it is essential to regulate the pressure down to 100 psig (6.9 bar) with Vortec's model 208R or 208RX pressure regulator. Operation at pressures less than 90 psig (6 bar) and above 100 psig (6.9 bar) will effect the operation. When properly sized for the application, the ProtEX Vortex A/C will maintain the internal enclosure temperature between 75–100°F (24–38°C). Enclosure temperatures can momentarily reach 125°F (52°C) during initial start-up and after long periods of inactivity. Variations in heat load and compressed air conditions can effect thermostat operation. The mechanical thermostat will regulate an internal valve to minimize compressed air usage and maintain enclosure temperatures within the range specified. In some applications, the ProtEX Vortex A/C may run continuously at lower air usage with the benefit of always keeping the enclosure under slight internal pressure. In other applications, the ProtEX Vortex A/C may cycle on and off to maintain enclosure temperatures. When the ProtEX Vortex A/C is not cooling, the Check Valves close shutting off the air passage from the enclosure interior to the exterior and allowing the purge/pressurization system to maintain slight pressure in the enclosure. Do not apply excessive heat or a flame to the mechanical thermostat to "test" it for operation as this will void the warranty.

NOTICE: The thermostat's reaction to temperature change depends on several factors: the internal and external heat loads, enclosure size and proximity to the heat source. When the internal heat load is zero (or very low) and when external temperatures are below +50°F (+10°C), the thermostat will take longer to react to air temperature increases. There will be a lag between the rising air temperature and when the thermostat reacts, which can result in temperatures inside the enclosure exceeding 125°F (52°C). When air and thermostat temperatures equalize, the reaction to temperature change is improved and the lag is minimized. This product is approved for use in ambient temperatures between 50° to 175°F (10° to 80°C).

Maintenance

WARNING: Potential Electrostatic charging hazard-clean the unit only with a damp cloth.

The only maintenance involved with the ProtEX Vortex A/C is normal element changes to the compressed air filter. The filter element should be changed when there is a decrease in performance or when pressure drop across the filter exceeds 15 psig (1.0 bar).

When the service life indicator on top of the filter is completely red, this is evidence of a 15 psig (1.0 bar) pressure drop. Follow the instructions below to change the filter element.

The compressed air supply to the unit must be shut off before changing the filter element. The compressed air filter should be located in a nonhazardous area so that normal filter element maintenance can be carried out without risk of hazardous substances entering the enclosure. If the compressed air filter must be located in the hazardous area, electric power to the enclosure must be shut off while performing filter maintenance and then routine purge system startup procedures should be followed when filter maintenance is complete and before power is applied to the enclosure.

The ProtEX Vortex A/C has only two moving parts (the mechanical thermostat/valve and the check valve) which are not serviceable in the field. Do not disturb the setting of the thermostat. Evidence of tampering with the thermostat will void the warranty.

If it is suspected that the compressed air filter has not been maintained after an extended period of operation, there may be pipe scale or foreign material in the ProtEX Vortex A/C. If the unit is not cooling sufficiently, there may be pipe scale or foreign material in the orifices of the generator(s) in the unit.

1. To check, shut off all electric power to the protected enclosure and follow any purge system shutdown procedures. Shut off the compressed air supply to the ProtEX Vortex A/C. Before opening the enclosure door, allow sufficient time for any internal components to cool down completely.
2. Detach the 5/8" (16 mm) ID vinyl tubing from the check valve assembly (assemblies, for dual units) and remove the check valve assembly (assemblies) from the cold air outlet fitting(s) of the ProtEX Vortex A/C.
3. Remove the brass cold air outlet fitting(s) from the bottom of the unit (with a 1" (25 mm) open end wrench).
4. Remove the O-Ring(s). Then remove the red, blue, or brown generator(s).
5. Inspect the six slots in each generator for foreign material and clean if necessary.
6. Clean each cavity in the ProtEX Vortex A/C that the generator(s) was (were) located in if necessary.
7. Reassemble the generator(s), O-Ring(s) and cold air outlet fitting(s) in reverse order. Tighten each cold outlet fitting to at least 100 inch pounds (11 newton meters) torque.
8. Attach the check valve assembly (assemblies) to the cold outlet fitting(s) making sure the air flow through the check valve(s) is (are) in the proper direction. Tighten all pipe connections securely. Re-attach the 5/8" (16 mm) vinyl tubing to the check valve outlet(s). Open the compressed air supply valve(s) to the ProtEX Vortex A/C. Follow purge system startup procedures before applying electric power to the enclosure.

Sizing the Spark Arrestor Vent to the ProtEX Vortex A/C

The ProtEX Vortex A/C must be used in conjunction with an enclosure purge and pressurization system. The purge system must have a spark arrestor vent that allows the cold air flow (produced by the ProtEX Vortex A/C) and the pressurization air flow to safely escape the protected enclosure, without creating too little or too much pressure in the enclosure. Add the pressurization air flow to the cold air flow as found in the table below to determine the total air flow through the spark arrestor vent.

PROTEX VORTEX A/C COLD AIR FLOW (AT 90 TO 100 PSIG (6-7 BAR) OPERATING PRESSURE)	
Vortec Model	Cold Air Flow
8115, 8115BSP	7 ft ³ /minute (198 liters/minute)
8125, 8125BSP	14 ft ³ /minute (396 liters/minute)
8135, 8135BSP	23.5 ft ³ /minute (665 liters/minute)
8170, 8170BSP	47 ft ³ /minute (1330 liters/minute)

Contact the purge system manufacturer or Vortec if assistance is needed in selecting the correct spark arrestor vent to allow proper purging and pressurization.

Elevated Surface Temperatures

Because the ProtEX Vortex A/C operates using the vortex principle, hot exhaust air is generated and released at low pressure from the opening in the stainless steel shroud on the back of the unit. This exhaust air can reach temperatures up to 225°F (107°C) under normal conditions. (Normal conditions are compressed air inlet pressure of 90–100 psig (6–6.9 bar) and compressed air inlet temperature of 70°F (21°C)). The ProtEX Vortex A/C models can be operated at compressed air temperatures that do not exceed 120°F (49°C). The ProtEX Vortex A/C models have a Temperature Class of T3.

Under fault conditions (blocked or partially blocked hot exhaust orifice) the hot exhaust air can exceed 225°F (107°C) but will not exceed 392°F (200°C). Under fault conditions the ProtEX Vortex A/C may not cool sufficiently. Contact Vortec or your Vortec representative for assistance.

Two Stage Cooling (For Dual Units)

Under normal operation, the first stage cooler (the cold air outlet that is nearest to the compressed air inlet) will activate first. This will either reduce the rate of temperature rise in the enclosure, or, it will begin to reduce the enclosure temperature, depending on the total heat load in the enclosure. If the total heat load is significant and the temperature continues to rise, the second stage cooler will activate, doubling the amount of cooling air. In locating the two Cold Air Ducting Kits, consideration should be given to the two stage cooling capability of the unit. The dual cold air outlets and Cold Air Ducting Kits provide for increased flexibility in directing refrigerated air into the enclosure. For example, the first stage cooler's output could be directed at a primary source of heat within the enclosure (PLC's, VFD's, transformers, etc.) and the second stage ducting could be punched or drilled (as described earlier) and routed for overall cold air distribution throughout the enclosure.

Limited Warranty and Product Replacement

ProtEX Vortex A/C compressed air enclosure cooling products manufactured by ITW Air Management will be replaced or repaired if found to be defective due to manufacture within three years from the date of invoice. The entire ProtEX Vortex A/C should be replaced after 3 years of operation (date reflected as "Expiration Date" on the product label) as some internal components may lose their functionality and the unit may no longer function as intended. Refer to our website www.vortec.com for full warranty details and limitations. ITW Air Management makes no specific warranty of merchantability or warrant of fitness for a particular purpose.

Troubleshooting

Insufficient cooling may be caused by the following:

1. Undersized compressed air line size.
2. Compressed air pressure at the cooler is too low.
3. Partial or complete blockage of internal compressed air paths, due to dirt.
4. Water vapor in the compressed air supply.
5. Loose cold air outlet fitting(s). This may occur if not tightened properly after being disassembled for cleaning.

If trouble persists, please contact Vortec at 1-800-441-7475.

ProtEX Vortex A/C Assembly

(Drawings shown below are not to scale)

Models 8115, 8125, 8135 and BSP versions

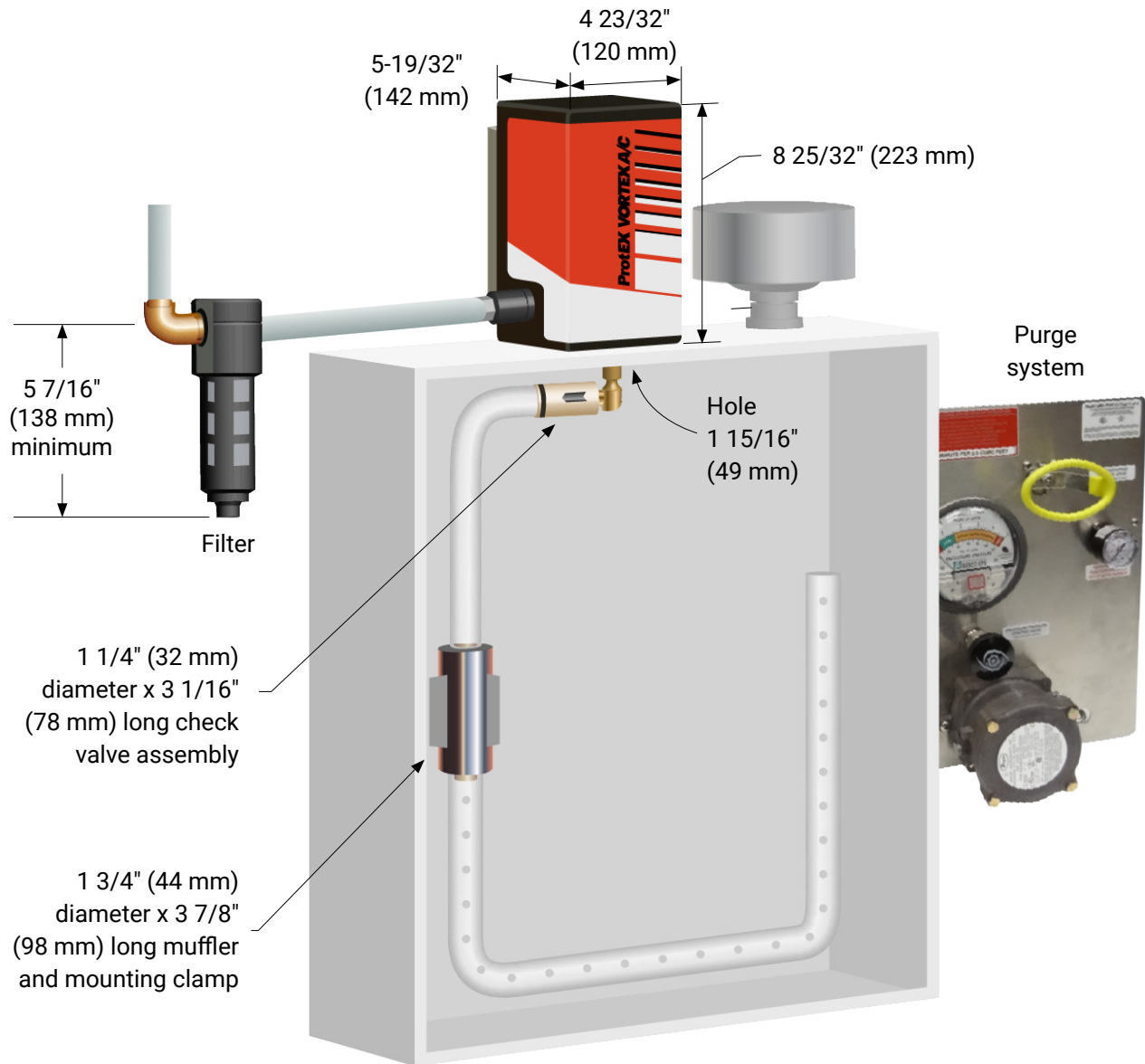

SHOWN TOP MOUNTED ON CUSTOMER'S ENCLOSURE
PURGE SYSTEM SHOWN FOR REFERENCE ONLY

ProtEX Vortex A/C Assembly

(Drawings shown below are not to scale)

Models 8170 and 8170BSP

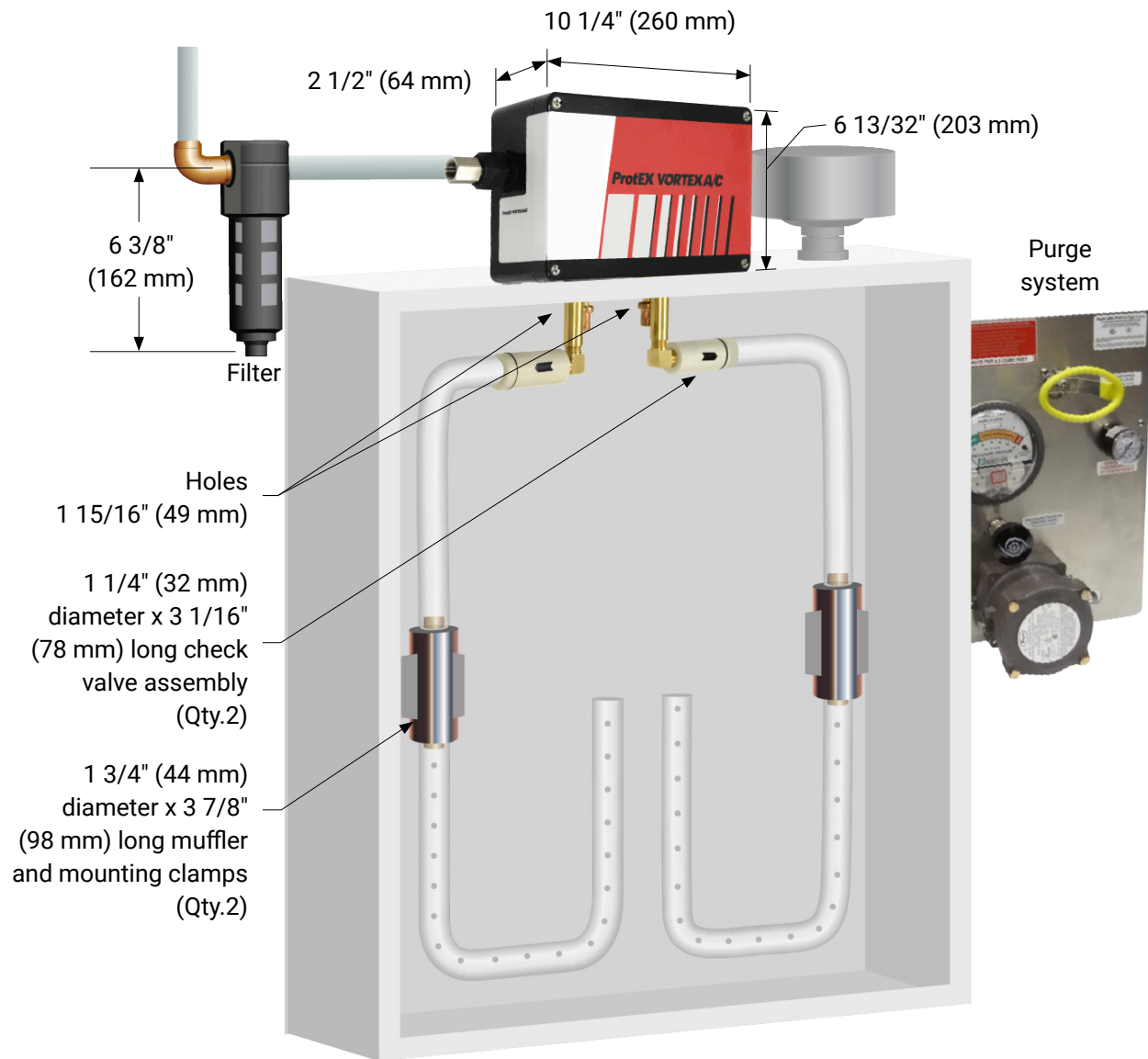

SHOWN TOP MOUNTED ON CUSTOMER'S ENCLOSURE
PURGE SYSTEM SHOWN FOR REFERENCE ONLY

Table 1: Filter Recommendations

FILTER AND REPLACEMENT PART ITEM NUMBERS		
Vortec Model	Oil Removal Filter	Replacement Generator Kits (5 pcs)
8115, 8115BSP	701S-48, 703S-48	208GK-15H
8125, 8125BSP	701S-48, 703S-48	208GK-25H
8135, 8135BSP	701S-54, 703S-54	208GK-35H
8170, 8170BSP	701S-54	208GK-35H

Table 2: Determining Compressed Air Line Size

1. Calculate total product compressed air consumption (SCFM, SLPM).
2. Determine length of compressed air line required for connection to main supply.
3. Locate pipe length in left column and read to the right to find the compressed air requirements.
4. Locate pipe size at top of column.

MAXIMUM AIRFLOW (SCFM) THROUGH PIPE AT 5 PSIG PRESSURE DROP (100 PSIG AND 70°F)									
Pipe Length (Feet)	Pipe Size (Nominal) - Schedule 40								
	1/4	3/8	1/2	3/4	1	1-1/4	1-1/2	2	2-1/2
10	29	65	120	254	480	978	1483	2863	4536
20	21	46	85	180	340	692	1049	2024	3208
30	17	37	70	147	277	565	856	1653	2619
40	15	32	60	127	240	489	792	1431	2268
50	13	29	54	114	215	437	663	1280	2029
60	12	26	49	104	196	399	606	1169	1852
70	11	25	46	96	181	370	561	1082	1715
80	10	23	43	90	170	346	524	1012	1604
90	10	22	40	85	160	326	494	954	1512
100	9	21	38	80	152	309	469	905	1435

MAXIMUM AIRFLOW (SLPM) THROUGH PIPE AT 0.3 BAR PRESSURE DROP (6.9 BAR AND 21°C)									
Pipe Length (Meters)	Pipe Size (Nominal) - Schedule 40								
	1/4	3/8	1/2	3/4	1	1-1/4	1-1/2	2	2-1/2
3	821	1840	3396	7188	13584	27677	42117	81023	128369
6	594	1302	2406	5094	9622	19584	29687	57279	90786
9	481	1047	1981	4160	7839	15990	24225	46780	74188
12	425	906	1698	3594	6792	13839	20999	40497	64184
15	368	821	1528	3226	6085	12367	18763	36224	57421
18	340	736	1387	2943	5547	11292	17150	33083	52412
21	311	708	1302	2717	5122	10471	15877	30621	48535
24	283	651	1217	2547	4811	9792	14829	28640	45393
27	269	623	1132	2406	4528	9226	13980	26998	42790
31	255	594	1075	2264	4302	8745	13273	25612	40611

Rubber hose maximum airflow rating: 1/2" I.D. rubber hose = 3/8" pipe; 3/4" I.D. rubber hose = 1/2" pipe